

CRETIN-DERHAM HALL STEM ADDITION

550 SOUTH ALBERT STREET,
ST PAUL, MINNESOTA

CRETIN-DERHAM HALL
550 SOUTH ALBERT STREET,
ST PAUL, MINNESOTA

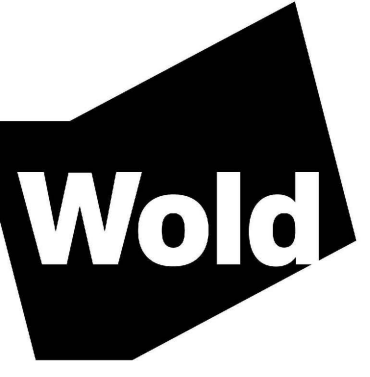

**WOLD ARCHITECTS
AND ENGINEERS**
332 Minnesota Street, Suite W2000
Saint Paul, MN 55101

woldac.com | 651.227.7773



MN

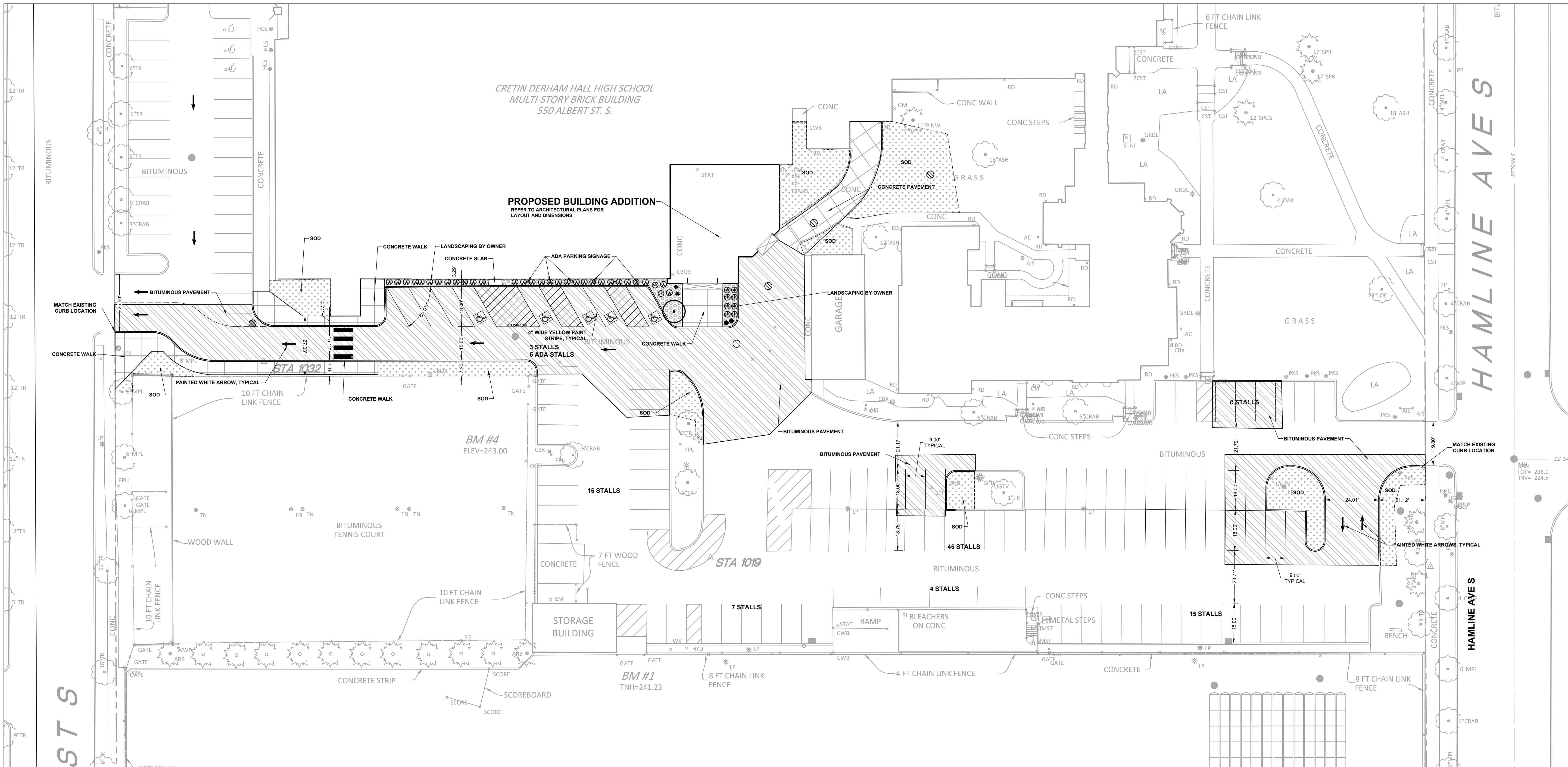

NOTES:

- REFER TO SHEET C1.31, GRADING AND DRAINAGE PLAN, FOR GENERAL NOTES.
- ALL APPLICABLE DIMENSIONS ARE TO FACE OF CURB, EDGE OF PAVEMENT, OR PROPERTY LINE UNLESS OTHERWISE NOTED.
- CHECK ALL PLAN AND DETAIL DIMENSIONS AND VERIFY SAME BEFORE FIELD LAYOUT.
- SALVAGED SIGNAGE SHALL BE INSTALLED AT LOCATIONS SHOWN ON PLAN. POSTS SHALL BE SET SQUARE AND PLUMB AT DEPTHS AND HEIGHTS TO MATCH EXISTING.
- ALL DISTURBED AREAS OUTSIDE THE BUILDING PAD WHICH ARE NOT DESIGNATED TO BE PAVED SHALL RECEIVE AT LEAST 6" OF TOPSOIL, SODDING AND RESTORATION BY OWNER.
- CONTRACTOR TO MAINTAIN ACCESS TO THE FIRE DEPARTMENT CONNECTION FOR FIRE DEPARTMENT PERSONNEL AT ALL TIMES DURING THE CONSTRUCTION PERIOD.

PARKING STATISTICS:

EXISTING PARKING STALLS:
101 STALLS
1 ADA STALLS
TOTAL = 102 STALLS

PROPOSED PARKING STALLS:
97 STALLS
5 ADA STALLS
TOTAL = 102 STALLS

LEGEND

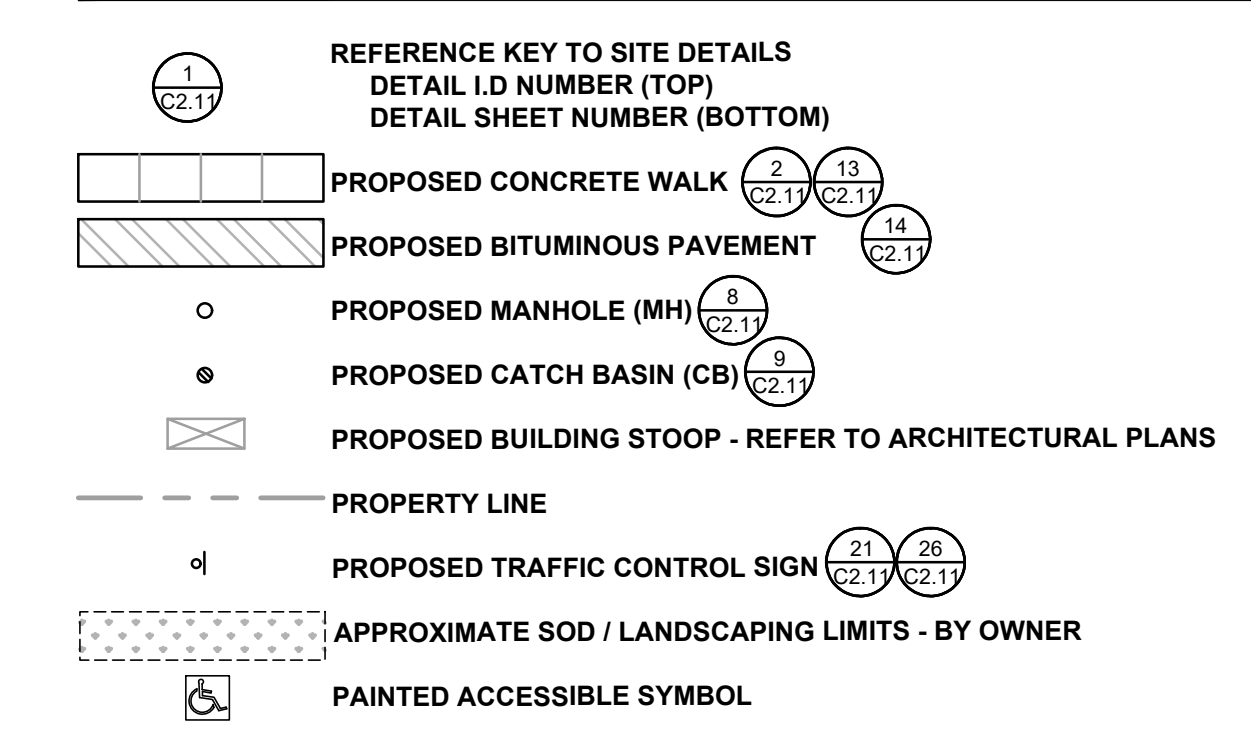

SIGNAGE KEY NOTES



LOT COVERAGE STATISTICS:

EXISTING GROUND COVER = 35.0%
IMPERVIOUS = 8.598 acres
PERVIOUS = 15.933 acres
TOTAL = 24.531 acres

PROPOSED GROUND COVER = 35.3%
IMPERVIOUS = 8.671 acres
PERVIOUS = 15.860 acres
TOTAL = 24.531 acres
INCREASE = 0.3%

I hereby certify that this plan, specification or report was prepared by me or under my direct supervision and that I am a duly Licensed PROFESSIONAL ENGINEER under the laws of the State of MINNESOTA

DAVID A. REY
Registration Number 40180 Date 2021.03.12

Revisions	Date	Num
SITE PLAN REVIEW	03/02/2021	

Comm: 212071
Date: 2021.03.12
Drawn: CLG
Check: DAR

SITE PLAN

Scale: 1" = 20'

**SITE PLAN REVIEW DRAWINGS
NOT FOR CONSTRUCTION**

C1.21