

Tap Room Licenses

...



Tap Room Licenses

- Tap Room and Brewery Licenses
 - Hours of Operation Sunday - Thursday (11am - 10pm), Friday and Saturday (11am - 12am).
 - Malt On-Sale (Brewery Taproom)
 - Liquor On-Sale: 181-290 seat
 - Liquor Outdoor Service Area (Patio)
- Growler (off Sale)
 - For the sale of Beverages NOT to be consumed on premises.
 - Includes Growler (64oz) and Crowler (25.4oz)
- Sales on Sunday

Entertainment License “B”

- All activities allowed in Class A, plus dancing by patrons to live, taped or electronically produced music, and which may also permit volleyball and broomball participated in by patrons or guests of the licensed establishment plus stage shows, theater, and contests. In all of the activities in Classes A and B, all of the participants, including patrons, shall be fully clothed at all times.
- Examples include:
 - Bands/Individual Performers
 - Trivia
 - Activities (Bean Bags)

Entertainment “A”

Amplified or non-amplified music and/or singing by performers without limitation as to number, and group singing participated in by patrons of the establishment.

Taproom/Brewery Layout

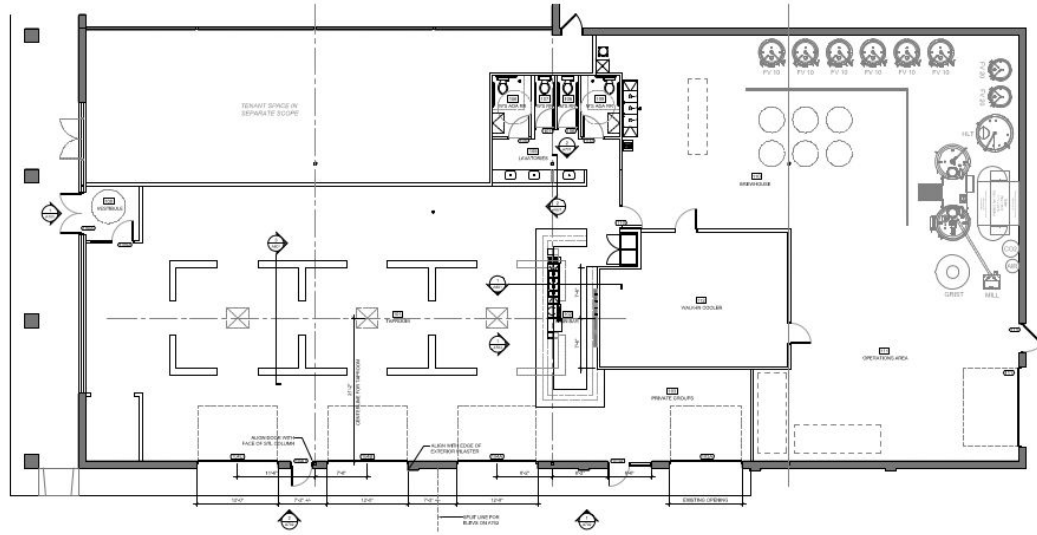

1 FLOOR PLAN
A101 3/16" = 1'-0"

ISSUE FOR PERMIT XX.XX.22

AWH
Architectural
Wandering Leaf Brewing Company
2483 West 7th Street, St. Paul, MN 55118
612.480.1234
www.wanderingleafbrewing.com

MITCHELL
2483 West 7th Street, St. Paul, MN 55118
612.480.1234
www.wanderingleafbrewing.com

WANDERING LEAF BREWING CO
2483 West 7th Street, St. Paul, MN 55118
Architect - Mechanical Division only

Project Name: Wandering Leaf Brewing Company Taproom/Brewery

Project Number: 2483 West 7th Street, St. Paul, MN 55118

Client: Wandering Leaf Brewing Company

Scale: 3/16" = 1'-0"

Issue: XX.XX.22

Issue For: PERMIT

FLOOR PLAN
A101

Patio Rendering from Paster Properties



Thank you

